

Technical Disclosure Commons

Defensive Publications Series

December 2022

MODULAR SPEAKER & WEBCAM WITH ON OFF SOLUTION IN ALL IN ONE

HP INC

Follow this and additional works at: https://www.tdcommons.org/dpubs_series

Recommended Citation

INC, HP, "MODULAR SPEAKER & WEBCAM WITH ON OFF SOLUTION IN ALL IN ONE", Technical Disclosure Commons, (December 13, 2022)

https://www.tdcommons.org/dpubs_series/5576



This work is licensed under a [Creative Commons Attribution 4.0 License](https://creativecommons.org/licenses/by/4.0/).

This Article is brought to you for free and open access by Technical Disclosure Commons. It has been accepted for inclusion in Defensive Publications Series by an authorized administrator of Technical Disclosure Commons.

Modular speaker & webcam with on off solution in All in One

Current Solution:

Current AIO webcam and speaker solution are integrate with system. For some special configuration can remove speaker driver or webcam daughter board from inside and keep the same appearance even without function. Also, there is no physical security switch can turn off both device and only control by software.



New Design Solution:

The modular webcam + speaker was design separate from main base and integrate in one speaker housing. The housing assembly with system hinge and have connector to transport signal between system board and module. The housing integrates with switch and can on/off speaker & webcam by rotate housing, rotate webcam also is one of physical solution to secure personal image when use webcam.

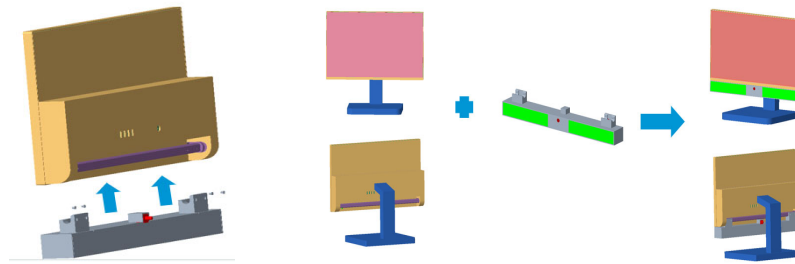

Design Detail:

- A: Connector (in hinge side) transport signal into system board
- B: Connector (in module side) fit into hinge connector and signal transport to system board.
- C: Physical Switch to turn on/ off speaker/webcam signal
- D: Speaker & webcam and switch signal all connector into daughter board

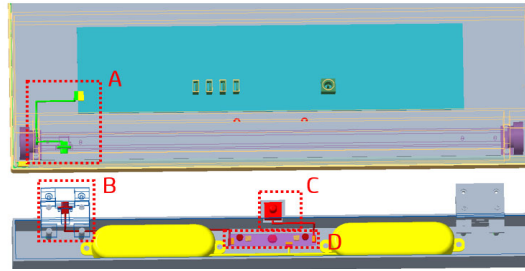

E: Push-push hinge to fix speaker in 90 degree and release

F: System hinge and module hinge have mechanical feature to assist module assembly.

G: Screw to fasten both module and system together.

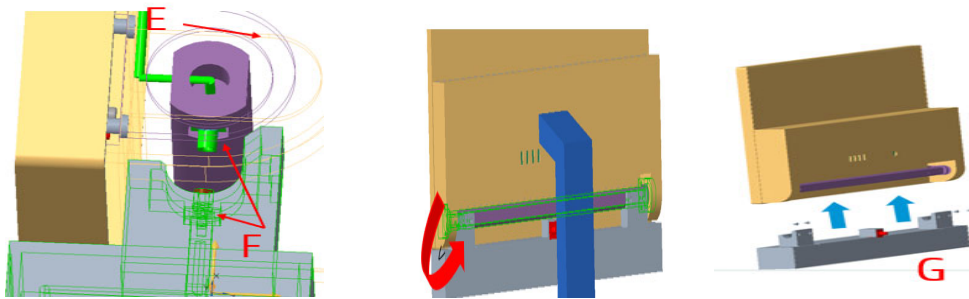

Operation and Function Arch:

Step1: Speaker module was assembly into system hinge and push speaker housing rotate over 90 degree. Hinge have push-push lock and release function (lock and release in 90 degree).

Step2: push housing to until hinge lock position and trigger on/off switch to turn on/off speaker&webcam.

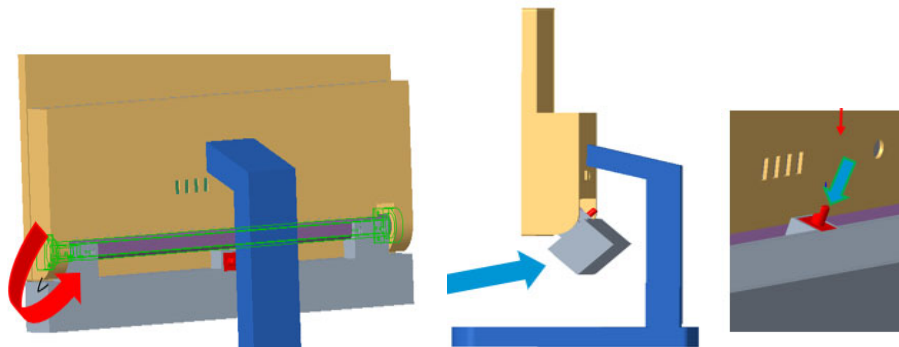

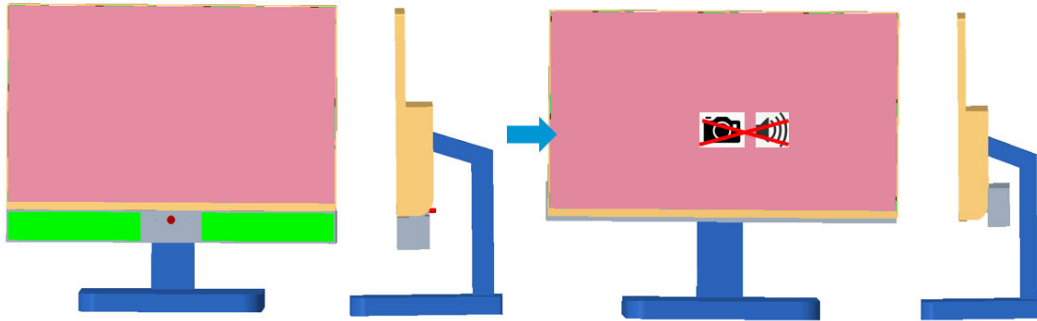

Disclosed by: Marc Tsai/Eric Tsao/Ken Chan/Sting Yu, HP Inc.